

Historic Resource Map

Downtown Anniston, Alabama

DOWNTOWN ANNISTON HISTORIC DISTRICT EXPANDED BOUNDARIES, 2009

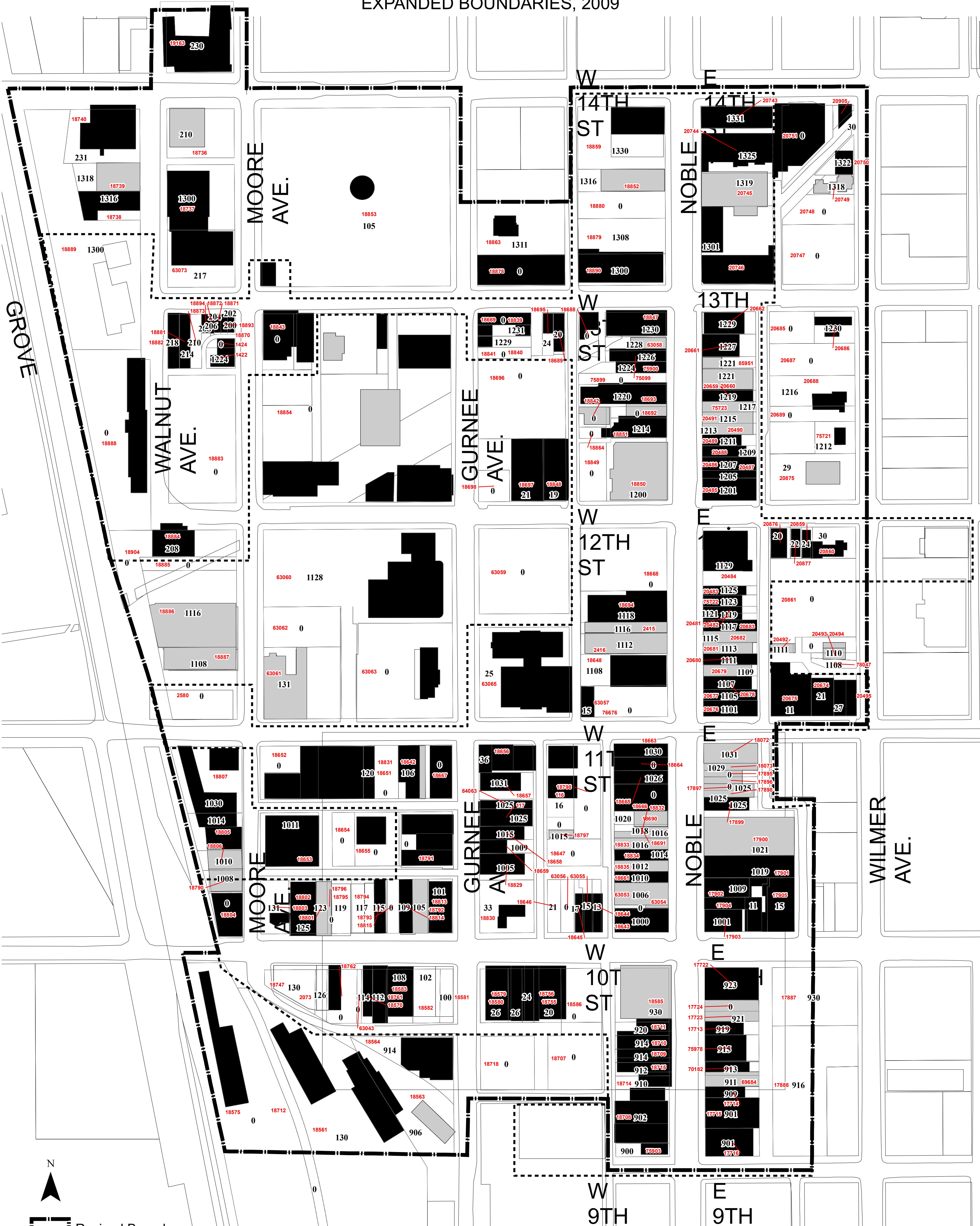

SCHNEIDER Historic Preservation, LLC
www.shphistoric.com

Prepared for P.S. King Associates

Revised and Reprinted By The East Alabama Regional Planning And Development Commission, 2014.

Parcel Data Obtained From The Calhoun County Mapping Department.

125 0 125 Feet